

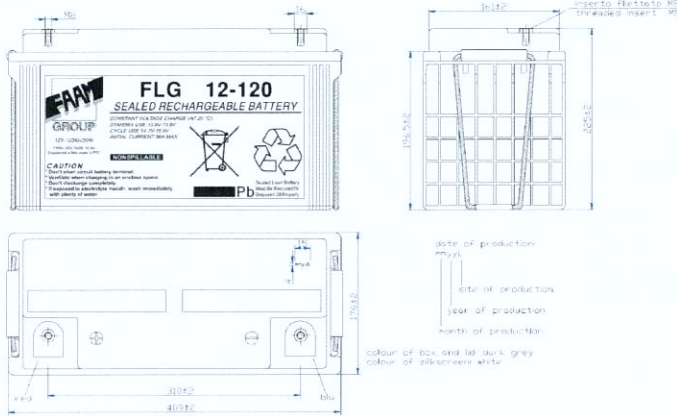

FLG 12-120

PHYSICAL SPECIFICATION

Nominal Voltage	12V	
Nominal Capacity (20Hr)	120Ah	
Dimension	Length	407 ±2mm
	Width	174 ±2mm
	Container Height	209 ±2mm
	Total Height	233 ±2mm
Drawing 400195-0	Weight 38,0 Kg ± 5%	
Standard Terminal	Bolt Type: M8	



Bolt-and-nut terminal
Bolt Type:M8

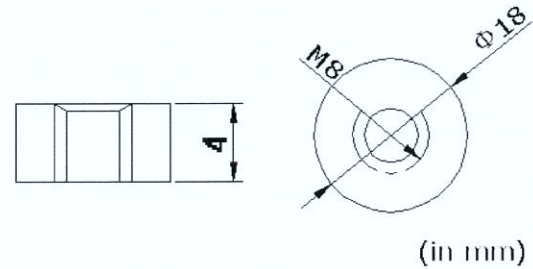

(in mm)

ELECTRICAL SPECIFICATION

Characteristics			Discharge curves @ 25°C (77 °F)
Capacity	20 hour rate	120,00Ah	<p>Discharge Characteristics(25°C/77 °F)</p>
	10 hour rate	100,00Ah	
	5 hour rate	86,45Ah	
	3 hour rate	76,98Ah	
	1 hour rate	52,49Ah	
Capacity affected by temperature	40°C	102%	
	20°C	100%	
	0°C	85%	
Internal Resistance 4,5 mΩ ±10%		SCC 2350 A ±10%	
Constant Voltage Charge	Cycle	Initial Charging Current less than 40 A Voltage 14,4~15,0V at 20°C Temperature Coefficient -30 mV/°C	
	Stand by	No limit on Initial Charging Current Voltage 13,5~13,8V at 20°C Temperature Coefficient -20 mV/°C	

Constant Current(Amp) and Constant Power (Watt/Cell) Discharge Table at 25°C

Time		5min	15min	30min	60min	90min	120min	180min	300min	480min	600min
9.9V	A	151,32	107,32	75,11	63,55	50,35	42,56	25,72	17,64	12,16	10,50
	W	442,61	332,74	219,28	140,98	114,20	86,04	56,67	38,92	29,10	24,36
10.2V	A	137,51	106,21	72,87	52,18	41,35	34,95	25,66	17,57	12,11	10,35
	W	430,49	322,11	212,46	136,60	110,65	83,37	56,34	38,69	28,93	24,31
10.8V	A	110,45	92,52	69,23	50,96	40,38	34,13	25,38	17,29	11,92	10,00
	W	404,21	303,88	200,44	128,87	104,39	78,65	55,23	37,93	28,36	23,83

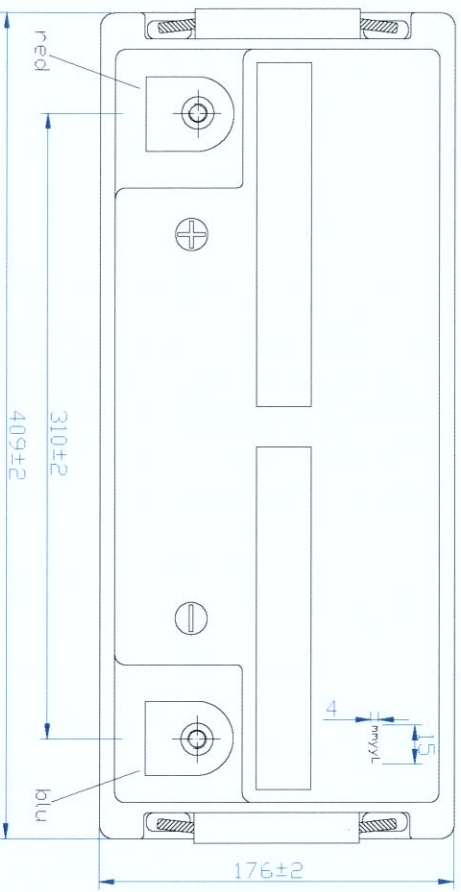
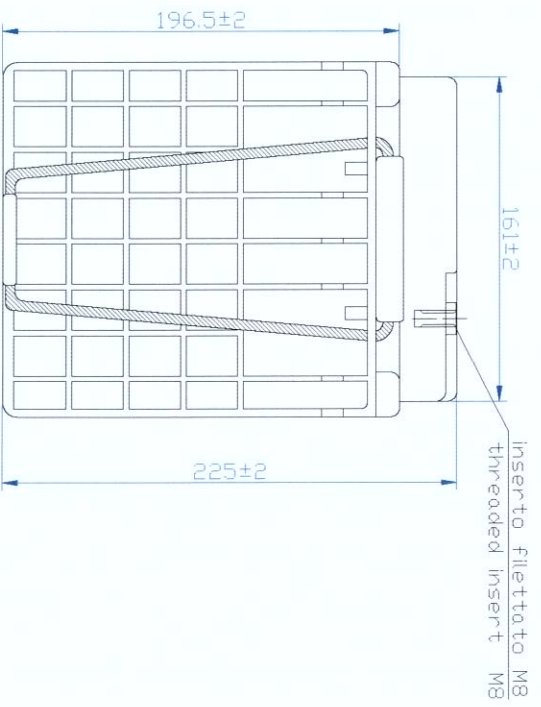
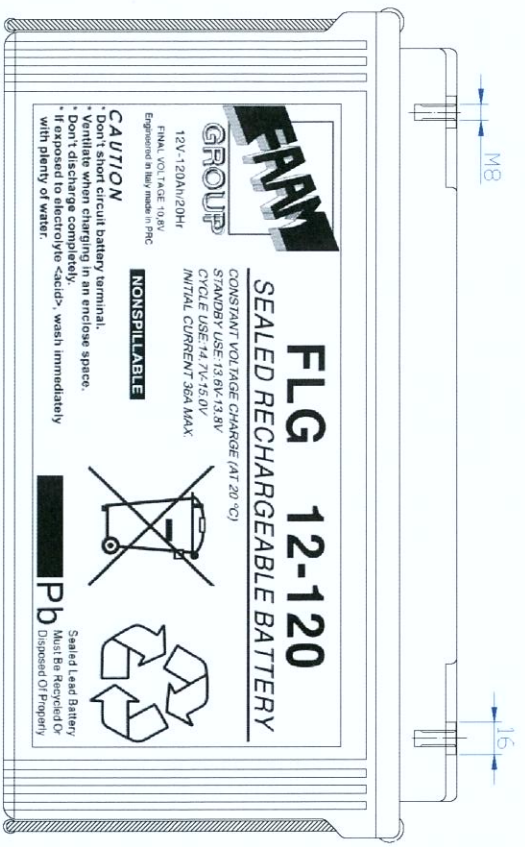

colour of box and lid: dark grey
 colour of silkscreen: white

date of production:
 mmyyL
 site of production
 year of production
 month of production

REV.	DATA DATE	PROGETTISTA/DESIGNER	DISIGNATO/DESIGN	APPROVATO/APPROVED	DESCRIZIONE MODIFICAZIONE/DESCRIPTION
		INDICAZIONE GENERALE/GENERAL INDICATION	NATIONAL/NATIONALE	® (UNICO)	DIREZIONE/WORKINGS
		GRADO DI PRECISIONE/DEGREE OF ACCURACY	ABS FV0 Pb/Ca		PROGETTISTA/DESIGNER
		NORMA UNI 5907/STANDARD UNI 5907	BATTERIE STAZIONARIE/STATIONARY BATTERY		DISIGNATO/DESIGNER
		SOSTITUIRE IL/APPENDICE	SOSTITUITO DA/APPENDICE BY	NOTE TELEFONICHE T.A.D.	PRODOTTO/PRODUCED
		SCALE/SCALE	FORMA/SHAPE	CODE/TYPE	DATA DATE
		1:2.5	A3	FLG 12-120	20.11.2006
		STANDARD/TYPE DESCRIZIONE		SERIES GEL	TRAV
		BATTERIA STAZIONARIA COD. FLG 12-120	12V 120Ah/20h gel/	CARICA/CHARGE	DRAWING N°/REV.
		STATIONARY BATTERY CODE FLG 12-120	12V 120Ah/20h gel		4 00195-0
					1



FAAM S.P.A. Via Month.11 63026 Monterubbiano (AP) ITALY
 Tel. ++39/07342581 Fax. ++39/0734258229 www.faam.com

Questo disegno è di proprietà della FAAM e non può essere riprodotto o reso noto senza autorizzazione scritta. This drawing is a proprietary and shall not be reproduced or released to otherwise authorized by FAAM.



12V-120Ah/20Hr

FINAL VOLTAGE 10,8V
Engineered in Italy made in PRC

CAUTION

- * Don't short circuit battery terminal.
- * Ventilate when charging in an enclose space.
- * Don't discharge completely.
- * If exposed to electrolyte <acid>, wash immediately with plenty of water.

FLG 12-120

SEALED RECHARGEABLE BATTERY

CONSTANT VOLTAGE CHARGE (AT 20 °C)

STANDBY USE:13.6V-13.8V

CYCLE USE:14.7V-15.0V

INITIAL CURRENT 36A MAX.

NONSPILLABLE

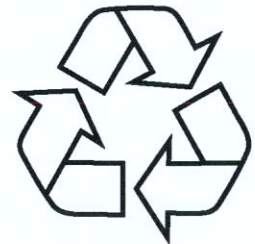

Pb

Sealed Lead Battery
Must Be Recycled Or
Disposed Of Properly