

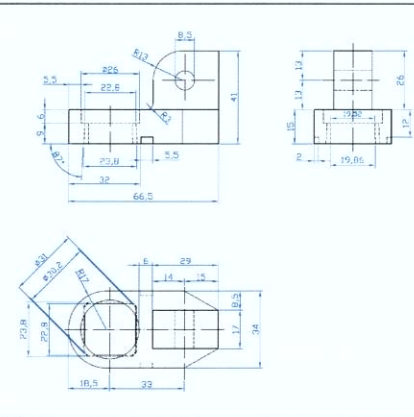

7STA70

PHYSICAL SPECIFICATION

Nominal Voltage		2V
Nominal Capacity (10Hr)		490Ah
Dimension	Length	166 ±2mm
	Width	206 ±2mm
	Container Height	518 ±2mm
	Total Height	548 ±2mm
Drawing 400188-0		Weight 37,5 Kg ± 5%
Standard Terminal		Bolt Type: S 8

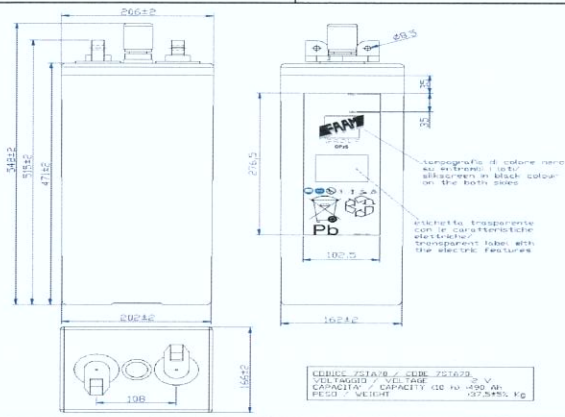

ELECTRICAL SPECIFICATION

Characteristics

Capacity	10 hour rate	490,00Ah
	8 hour rate	479,84Ah
	5 hour rate	418,45Ah
	3 hour rate	381,75Ah
	1 hour rate	266,36Ah
Capacity affected by temperature	40°C	102%
	20°C	100%
	0°C	85%
Internal Resistance 0,38 mΩ±10%		SCC 5880 A ±10%
Charge Voltage	Standby	Max Charge Current 100 A Floating Voltage 2,23V at 20°C Bost Charge 2,40V at 20°C Temperature Coefficient -20 mV/°C

Charging curves @ 20°C

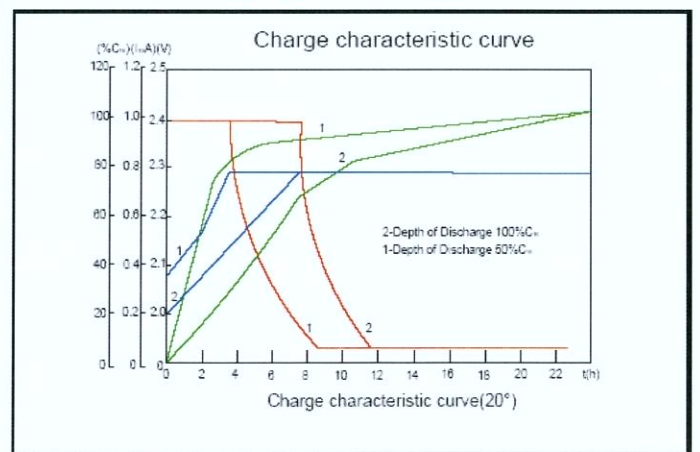

Constant Current(Amp) and Constant Power (Watt/Cell) Discharge Table at 20°C

Time		30 min	60 min	90 min	2 h	3 h	5 h	8 h	10 h	100 h	120 h
1,65V	A	363,09	259,70	202,70	172,54	132,06	88,71	61,74	51,45	6,66	5,65
	W	713,39	472,31	361,97	305,76	229,45	159,87	114,20	92,61	12,02	10,20
1,70V	A	343,54	251,94	198,70	169,13	127,25	87,88	61,15	50,96	6,72	5,70
	W	680,21	456,44	349,27	295,39	222,99	159,12	113,66	92,05	11,97	10,16
1,80V	A	279,30	221,97	181,79	154,74	120,05	83,69	58,80	49,00	6,46	5,48
	W	553,01	396,90	317,52	273,00	208,59	150,82	107,43	88,20	11,63	9,87

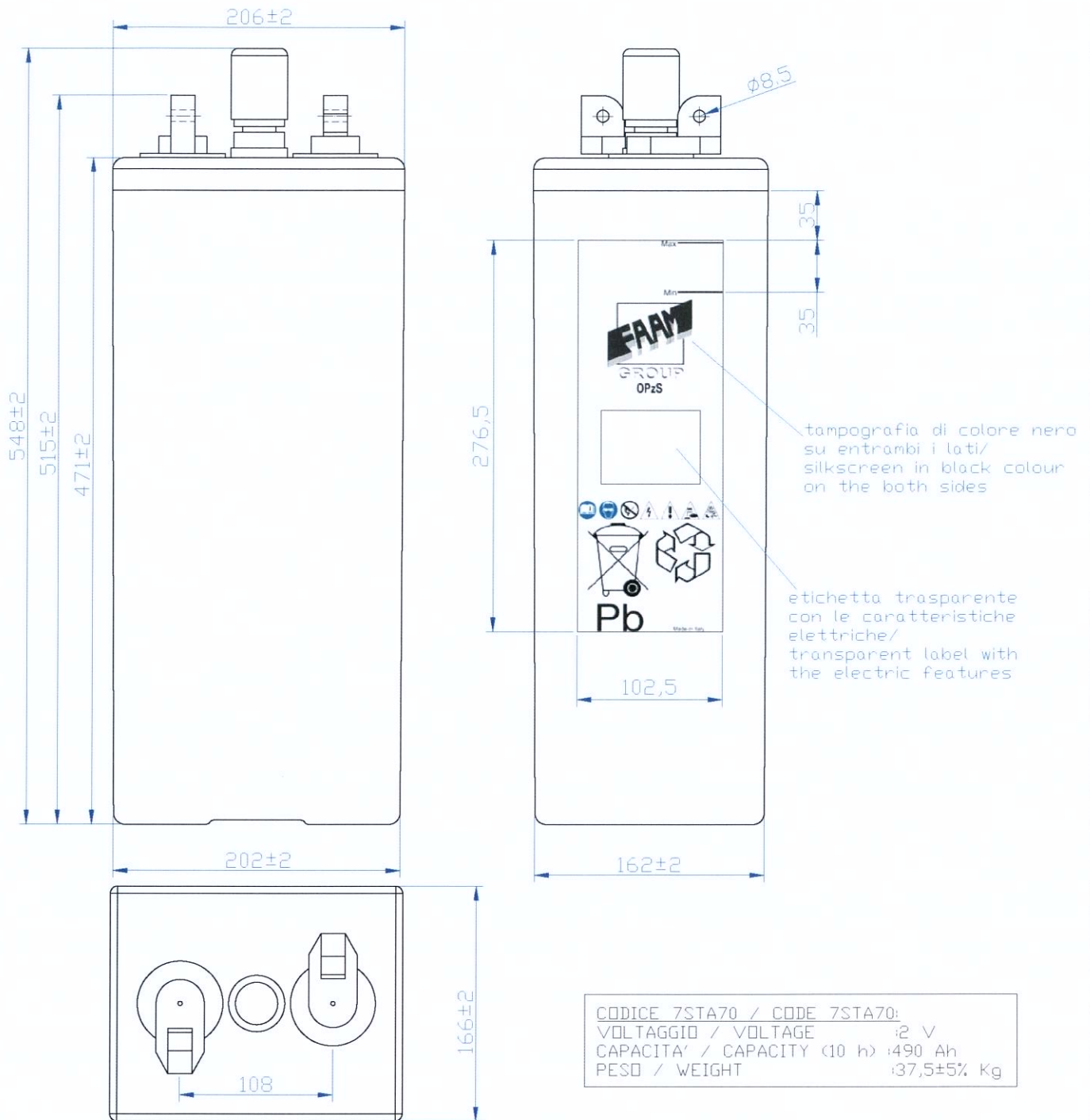

1	14.02.2011	R. PARENTI	S. BALDASSARRI	R. ISIDORI	INSERITA TAMPOGRAFIA/ADDED PRINTING		
REV.	DATA/DATE	PROGETTISTA/DESIGNER	DISEGNATO/DRAWN	APPROVATO/APPROVED	DESCRIZIONE MODIFICHE/DESCRIPTION REVISIONS		
INDICAZIONI GENERALI/GENERAL INDICATION:			MATERIALE/MATERIAL:	R (N/nm2)	DUREZZA/HARDNESS:	PROGETTISTA/DESIGNER:	
GRADO DI PRECISIONE/DEGREE OF ACCURACY			Pb-acide			R. PARENTI	
NORMA UNI 5307/STANDARD UNI 5307			PROGETTO GENERALE-COMPLESSIVO/GENERAL PLAN-TOTAL PLAN:			DISEGNATO/DRAWN:	
			ELEMENTI STAZIONARI ACIDO LIBERO/STATIONARY CELLS OPZS			S. BALDASSARRI	
SOSTITUISCE IL/SUPERSEDES:		SOSTITUITO DAL/SUPERSEDS BY:	NOME FILE/NAME FILE:			APPROVATO/APPROVED:	
			4 00188-1.dwg			F. PAGLIARINI	
SCALA/SCALE:		FOGLIO/SHEET:	CODICE/COE:	TIPO/TYPE:	VERSIONE/VERSION:	DATA/DATE:	
1:4		A4	7STA70	VASO APERTO/OPZS	CARICA/CHARGE	07.11.2006	
DENOMINAZIONE/PART DESCRIPTION:						DISEGNO N°-REV./DRAWING N°-REV.:	TAV.
ELEMENTO STAZIONARIO ACIDO LIBERO COD. 7STA70/ STATIONARY CELL OPZS CODE 7STA70						4 00188-1	1



FAAM S.p.A. Via Monti,11 63026 Monterubbiano (AP) ITALY
Tel. ++39/07342581 Fax. ++39/0734258229 www.faam.com

Questo disegno è di proprietà della FAAM e non può essere riprodotto o reso noto senza autorizzazione scritta.
This drawing is a proprietary and shall not be reproduced or released to otherwise authorized by FAAM.