

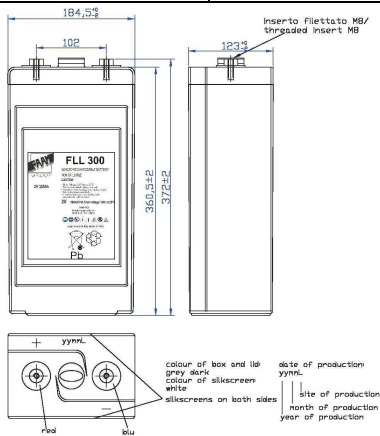

FLL-300

PHYSICAL SPECIFICATION

Nominal Voltage		2V		Box material : ABS FV0 Tensione di mantenimento a 20°C 2,27±0,02V/el Tensione di carica rapida 2,40±0,02V/el Autoscarica a 20°C 2%/mese Terminal hardware torque: 15 ±1 Nm Max charge current allowed :100A Tecnologia AGM 1200 cicli all'80%DOD Design cycles 15 years
Nominal Capacity (10Hr)		300Ah (1,80V) at 20°C		
Dimensions	Length	123 ±2mm		
	Width	184,5 ±2mm		
	Box Height	360,5 ±2mm		
	Total Height	372 ±2mm		
Drawing 4 00379-0		Weight 18,5 Kg ± 5%		
Standard Terminal		Bolt Screw Type: M8 female		



Bolt-and-nut terminal
Bolt Type:M8

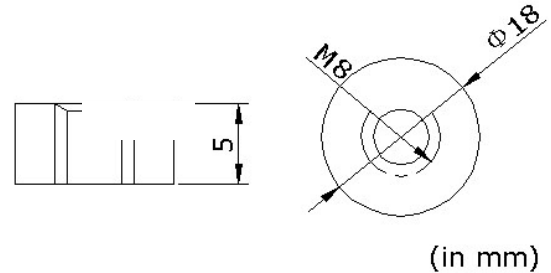

ELECTRICAL SPECIFICATION

Characteristics			Discharge curves @ 25°C (77 °F)	
Capacity	10 hour rate (1,80V) 3 hour rate (1,80V) 1 hour rate (1,75V)	300,00Ah 225,00Ah 165,00Ah		
Capacity affected by temperature	40°C 20°C 0°C	102% 100% 85%		
Internal Resistance	0,47 mΩ ±10%	SCC 4200 A ±10%		
Constant Voltage Charge	Stand by	Voltage 2,25V at 20°C Temperature Coefficient -20 mV/°C		

Constant Current(Amp) and Constant Power (Watt/Cell) Discharge Table at 20°C

Time		15min	30min	60min	2hour	3hour	4hour	5hour	8hour	10hour	24hour
1.65V	A	390	297	186	113	82,7	66,2	56,1	39	32,5	14,5
	W	683	536	373	239	181	146	123	82	67,8	31,1
1.70V	A	366	273	178	109	80,3	65,3	55,6	38,3	32,0	14,4
	W	659	523	355	232	175	141	120	80,2	65,8	30,2
1.80V	A	327	238	159	100	75,0	61,4	52,8	37,1	30,0	14
	W	604	487	334	220	162	134	114	75,2	63,9	29,3