	<h1>6STG70</h1>
---	-----------------

### PHYSICAL SPECIFICATION

Nominal Voltage		2V	Container and lid ABS, FV0 on request
Nominal Capacity (10Hr)		420Ah	
Dimension	Length	206 ±2mm	
	Width	145 ±2mm	
	Container Height	470 ±2mm	
	Total Height	494 ±2mm	
Drawing 400305-0		Weight	36,0 Kg ± 5%
Standard Terminal		Bolt Type: M10	

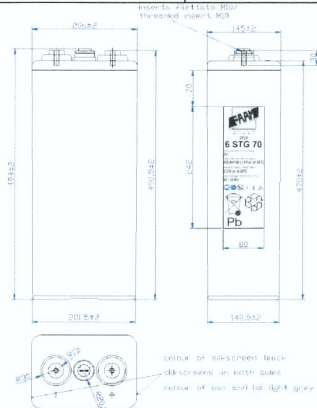

Bolt-and-nut terminal  
Bolt Type: **M10**

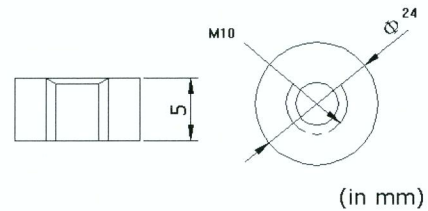

### ELECTRICAL SPECIFICATION

Characteristics			Charging curves @ 20°C	
Capacity	10 hour rate	420,00Ah		
	8 hour rate	391,68Ah		
	5 hour rate	357,00Ah		
	3 hour rate	324,36Ah		
	1 hour rate	282,24Ah		
Capacity affected by temperature	40°C	102%		
	20°C	100%		
	0°C	85%		
Internal Resistance 0,55 mΩ±10%		SCC 4350 A ±10%		
Charge Voltage	Standby	Max Charge Current 80 A Floating Voltage 2,23V at 20°C Boost Charge 2,35V at 20°C Temperature Coefficient -20 mV/°C		

### Constant Current(Amp) and Constant Power (Watt/Cell) Discharge Table at 25°C

Time		30 min	60 min	90 min	2 h	3 h	5 h	8 h	10 h	100 h	120 h
1,65V	A	385,56	262,08	216,60	145,60	112,20	72,08	50,40	44,10	5,71	4,84
	W	631,80	492,80	404,24	322,56	247,50	163,13	113,40	94,50	11,24	9,59
1,70V	A	372,60	250,88	209,00	140,40	108,12	71,40	49,92	43,68	5,76	4,89
	W	631,80	492,80	404,24	322,56	247,50	163,13	113,40	94,50	11,24	9,59
1,80V	A	324,00	224,00	190,00	130,00	102,00	68,00	48,00	42,00	5,54	4,70
	W	540,00	421,20	354,60	288,00	225,00	153,90	108,00	90,00	10,91	9,32

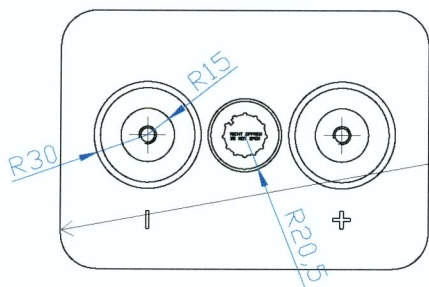
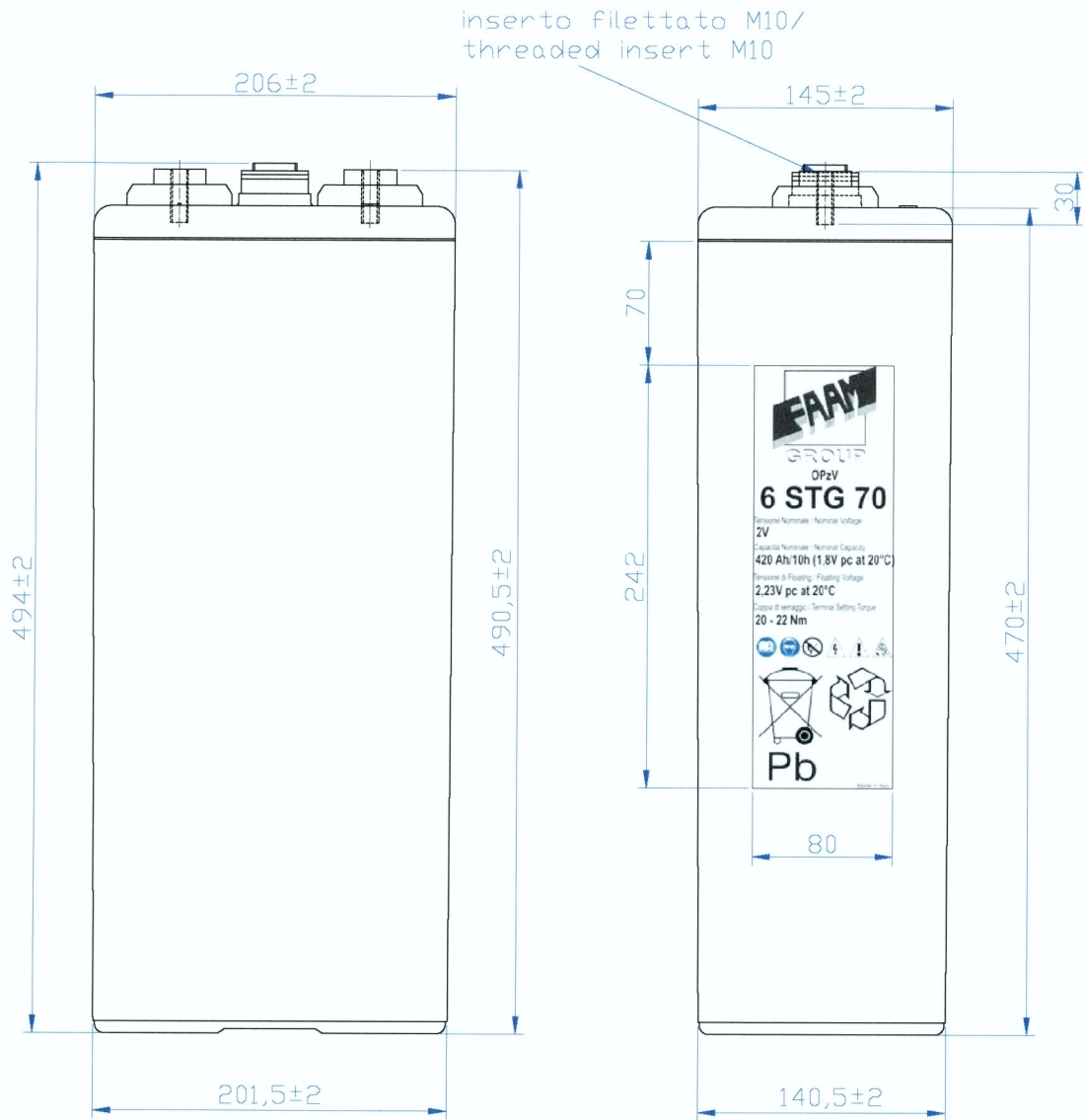

colour of silkscreen: black  
 silkscreens on both sides  
 colour of box and lid: light grey

REV.	DATA/DATE	PROGETTISTA/DESIGNER	DISEGNATO/DRAWN	APPROVATO/APPROVED	DESCRIZIONE MODIFICHE/DESCRIPTION REVISIONS		
INDICAZIONI GENERALI/GENERAL INDICATION			MATERIALE/MATERIAL:	R (N/nr2):	DUREZZA/HARDNESS:	PROGETTISTA/DESIGNER:	
GRADO DI PRECISIONE/DEGREE OF ACCURACY			ABS/Pb-Ca			R. PARENTI	
NORMA UNI 5307/STANDARD UNI 5307			PROGETTO GENERALE-COMPLESSIVO/GENERAL PLAN-TOTAL PLAN			DISEGNATO/DRAWN:	
			ELEMENTI STAZIONARI/STATIONARY CELLS			S. BALDASSARRI	
SOSTITUISCE IL/SUPERSEDES:		SOSTITUITO DAL/SUPERSEDS BY:	NOME FILE/NAME FILE:		APPROVATO/APPROVED:		
			4 00305.dwg		F. PAGLIARINI		
SCALA/SCALE:		FOGLIO/SHEET:	CODICE/COE:	TIPO/TYPE:	VERSIONE/VERSION:	DATA/DATE:	
1:4		A4	6STG70	Series STG GEL	CARICA/CHARGE	18.05.2010	
DENOMINAZIONE/PART DESCRIPTION:						DISEGNO N°-REV./DRAWING N°-REV.:	TAV.:
ELEMENTO STAZIONARIO COD. 6STG70 (420Ah/10h) 2V gel/ STATIONARY CELL CODE 6STG70 (420Ah/10h) 2V gel						4 00305-0	1



**FAAM S.p.A.** Via Monti,11 63026 Monterubbiano (AP) ITALY  
 Tel. ++39/07342581 Fax. ++39/0734258229 [www.faam.com](http://www.faam.com)

Questo disegno è di proprietà della FAAM e non può essere riprodotto o reso noto senza autorizzazione scritta.  
 This drawing is a proprietary and shall not be reproduced or released to otherwise authorized by FAAM.

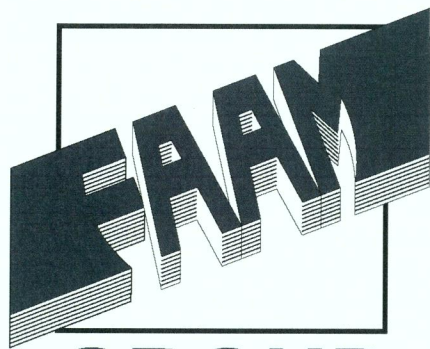

GROUP

OPzV

# 6 STG 70

Tensione Nominale / Nominal Voltage

**2V**

Capacità Nominale / Nominal Capacity

**420 Ah/10h (1,8V pc at 20°C)**

Tensione di Floating / Floating Voltage

**2,23V pc at 20°C**

Coppia di serraggio / Terminal Setting Torque

**20 - 22 Nm**

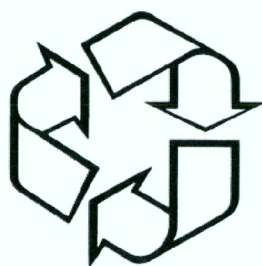
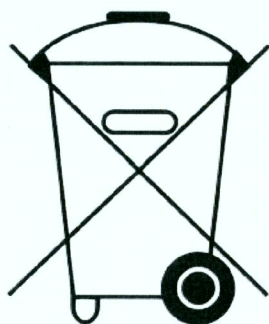

# Pb

Made in Italy