

# Hi-MO X6 Explorer

## LR5-66HTH 520~540M

- Suitable for Distribution Market
- Simple design embodies modern style
- Better energy generation performance
- High-quality module guarantees long-term reliability

15

15-year Warranty for  
Materials and Processing

25

25-year Warranty for Extra  
Linear Power Output

### Complete System and Product Certifications

IEC 61215, IEC 61730, UL 61730

ISO9001:2015: ISO Quality Management System

ISO14001: 2015: ISO Environment Management System

ISO45001: 2018: Occupational Health and Safety

IEC62941: Guideline for module design qualification and type approval

**LONGI**



**22.7%**  
MAX MODULE  
EFFICIENCY

**0~3%**  
POWER  
TOLERANCE

**<1.5%**  
FIRST YEAR  
POWER DEGRADATION

**0.40%**  
YEAR 2-25  
POWER DEGRADATION

## Additional Value

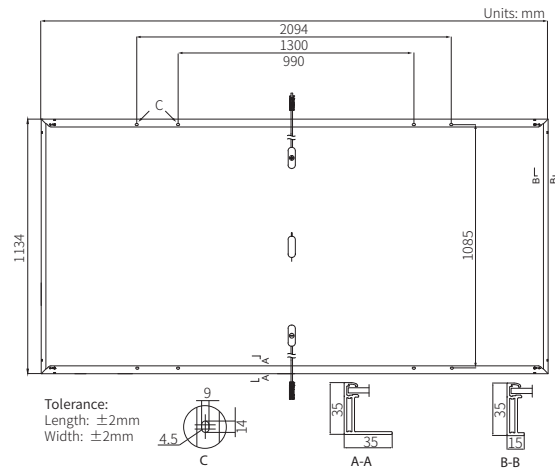
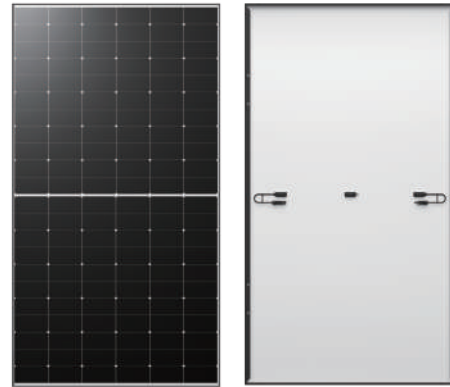
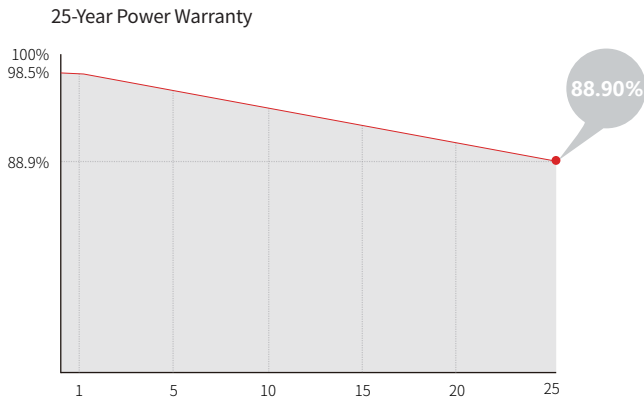

## Mechanical Parameters

Cell Orientation	132 (6×22)
Junction Box	IP68
Output Cable	4mm <sup>2</sup> , +400, -200mm/ $\pm 1400\text{mm}$ length can be customized
Glass	Single glass, 3.2mm coated tempered glass
Frame	Anodized aluminum alloy frame
Weight	26.0kg
Dimension	2094×1134×35mm
Packaging	31pcs per pallet / 155pcs per 20' GP / 682pcs per 40' HC

## Electrical Characteristics

STC : AM1.5 1000W/m<sup>2</sup> 25°C

NOCT : AM1.5 800W/m<sup>2</sup> 20°C 1m/s

Test uncertainty for Pmax:  $\pm 3\%$

Module Type	LR5-66HTH-520M		LR5-66HTH-525M		LR5-66HTH-530M		LR5-66HTH-535M		LR5-66HTH-540M	
	STC	NOCT	STC	NOCT	STC	NOCT	STC	NOCT	STC	NOCT
Maximum Power (Pmax/W)	520	388.6	525	392.3	530	396.0	535	399.8	540	403.5
Open Circuit Voltage (Voc/V)	48.27	45.32	48.42	45.46	48.57	45.60	48.72	45.75	48.87	45.89
Short Circuit Current (Isc/A)	13.84	11.18	13.93	11.25	14.00	11.31	14.07	11.37	14.15	11.43
Voltage at Maximum Power (Vmp/V)	39.91	36.42	40.06	36.55	40.22	36.70	40.38	36.85	40.53	36.99
Current at Maximum Power (Imp/A)	13.03	10.68	13.11	10.74	13.18	10.80	13.25	10.86	13.33	10.92
Module Efficiency(%)	21.9		22.1		22.3		22.5		22.7	

## Operating Parameters

Operational Temperature	-40°C ~ +85°C
Power Output Tolerance	0 ~ 3%
Maximum System Voltage	DC1500V (IEC/UL)
Maximum Series Fuse Rating	25A
Nominal Operating Cell Temperature	45 $\pm$ 2°C
Protection Class	Class II
Fire Rating	UL type 1 or 2 IEC Class C

## Mechanical Loading

Front Side Maximum Static Loading	5400Pa
Rear Side Maximum Static Loading	2400Pa
Hailstone Test	25mm Hailstone at the speed of 23m/s

## Temperature Ratings (STC)

Temperature Coefficient of Isc	+0.050%/°C
Temperature Coefficient of Voc	-0.230%/°C
Temperature Coefficient of Pmax	-0.290%/°C

# Axpert MAX Off-Grid Inverter



- Customizable status LED bar with RGB lights
- Built-in wifi for mobile monitoring (Android/iOS Apps are available)
- Supports USB On-the-Go function
- Reserved communication port for BMS (RS485, CAN-BUS or RS232)
- Replaceable fan design for ease of maintenance
- Battery independent design
- Configurable AC/PV output usage timer and prioritization
- Selectable high power charging current
- Selectable input voltage range for home appliances and personal computers
- Compatible to Utility Mains or generator input
- Built-in anti-dust kit
- Optional DC output for DC fan, LED bulb, router and so on
- Parallel operation up to 6 units only available for 7.2kVA

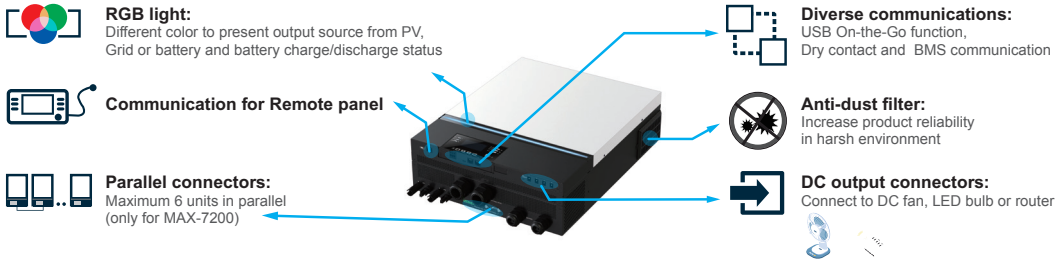

## Axpert MAX Off-Grid Inverter Selection Guide

MODEL	Axpert MAX 3600-24-230	Axpert MAX 7200-48-230
Rated Power	3600VA/3600W	7200VA/7200W*
PARALLEL CAPABILITY	NO	Yes, up to 6 units
<b>INPUT</b>		
Voltage	230 VAC	230 VAC
Selectable Voltage Range	170-280 VAC (For Personal Computers) 90-280 VAC (For Home Appliances)	170-280 VAC (For Personal Computers) 90-280 VAC (For Home Appliances)
Frequency Range	50 Hz/60 Hz (Auto sensing)	
<b>OUTPUT</b>		
AC Voltage Regulation (Batt. Mode)	230VAC ± 5%	230VAC ± 5%
Surge Power	7500VA	15000VA
Efficiency (Peak)	90% ~ 93%	
Transfer Time	15 ms (For Personal Computers) ; 20 ms (For Home Appliances)	
Waveform	Pure sine wave	
No Load Power Consumption	< 45W	< 70W
<b>BATTERY</b>		
Battery Voltage	24 VDC	48 VDC
Floating Charge Voltage	27 VDC	54 VDC
Overcharge Protection	33 VDC	66 VDC
<b>SOLAR CHARGER &amp; AC CHARGER</b>		
Solar Charger Type	MPPT	
Maximum PV Array Power	4000 W	8000W (4000W x 2)
MPPT Range @ Operating Voltage	120 ~ 450 VDC	90 ~ 450 VDC
Maximum PV Array Open Circuit Voltage	500 VDC	500 VDC
Maximum Solar Charge Current	80 A	
Maximum AC Charge Current	80 A	
Maximum Charge Current	80 A	
<b>PHYSICAL</b>		
Dimension, D x W x H (mm)	147.4 x 432.5 x 553.6	
Net Weight (kgs)	14.1	18.4
Communication Interface	USB/RS232/RS485/Wifi/Dry-contact	
<b>OPERATING ENVIRONMENT</b>		
Humidity	5% to 95% Relative Humidity(Non-condensing)	
Operating Temperature	-10°C to 50°C	
Storage Temperature	-15°C to 60°C	
<b>STANDARD</b>		
Compliance Safety	CE	CE

Product specifications are subject to change without further notice.

# SUPER CAPACITOR ENERGY STORAGE MODULE

## FEATURES

- Graphene supercapacitor cells
- Safest technology
- Ultra-long cycle life
- Extreme temperature
- Highest energy transfer efficiency
- Easy to install
- Rarely maintenance
- 10 years warranty



<b>Energy storage</b>	3.6kWh
<b>Nominal Voltage</b>	48V/DC
<b>Maximum Charge Voltage</b>	58V/DC
<b>Discharge Cut-off Voltage</b>	37.8V/DC
<b>ESR/AC @1KHz 50% SOC</b>	<15mΩ
<b>Max. Continuous Charge Current</b>	100A
<b>Max. Continuous Discharge Current</b>	100A
<b>Power/Energy</b>	1.38
<b>Round Trip Efficiency*1</b>	95%
<b>Cells Self-discharge Rate</b>	2% per month
<b>Projected Cycle Life (25°C)</b>	20,000 times
<b>Recommended Depth of Discharge</b>	≤90%
<b>Maximum Depth of Discharge</b>	100%
<b>Cooling Method</b>	Natural
<b>Shell Material</b>	Metal & ABS plastic
<b>Parallel Connection</b>	Up to 10sets
<b>Monitoring Data</b>	System voltage, current, temperature, SOC, SOH, cycle, cell's voltage

Remark: \*1 (1) At room temperature 25 °C, charge-discharge at 100A. (2) Limited charge at 100A for resident energy storage, (3) At the beginning of life.

## COMPLIANCE INFORMATION

Safety	IEC62619
Transport	UN38.3, MSDS
CE	EN 62133:2013, EN 55032:2015+AC:2016, EN 55035:2017, EN 61000-3-2:2014, EN 61000-3-3:2013
Environmental	RoHS

## ENVIRONMENTAL SPECIFICATIONS

Environmental Protection	IP20
Operating Humidity	0~90% RH Non-condensing
Charge Temperature	0°C ~ +55°C
Discharge Temperature	-20°C ~ +60°C
Storage Conditions	-20°C ~ +40°C, 25% ~ 95% RH SOC>30% one full charge needed per two months

# UFLEX SUPER CAPACITOR ENERGY STORAGE MODULE

MECHANICAL SPECIFICATIONS	
Part Number	22133VG
Weight	42Kg
Dimensions (W x D x H)	475 x 465 x 177(mm)
Mount Options	On floor

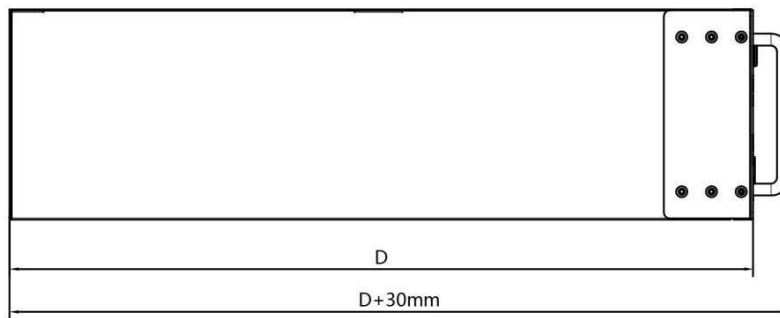
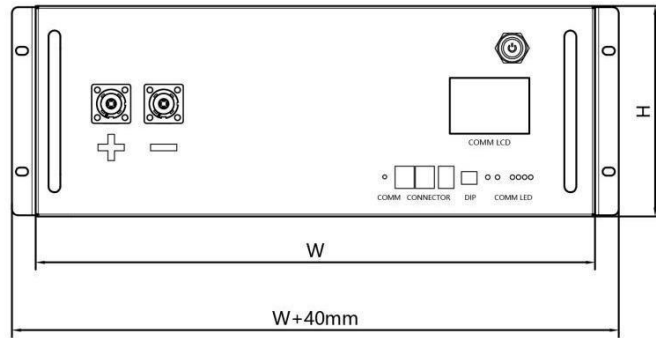

## CHARGING-DISCHARGING CURVE

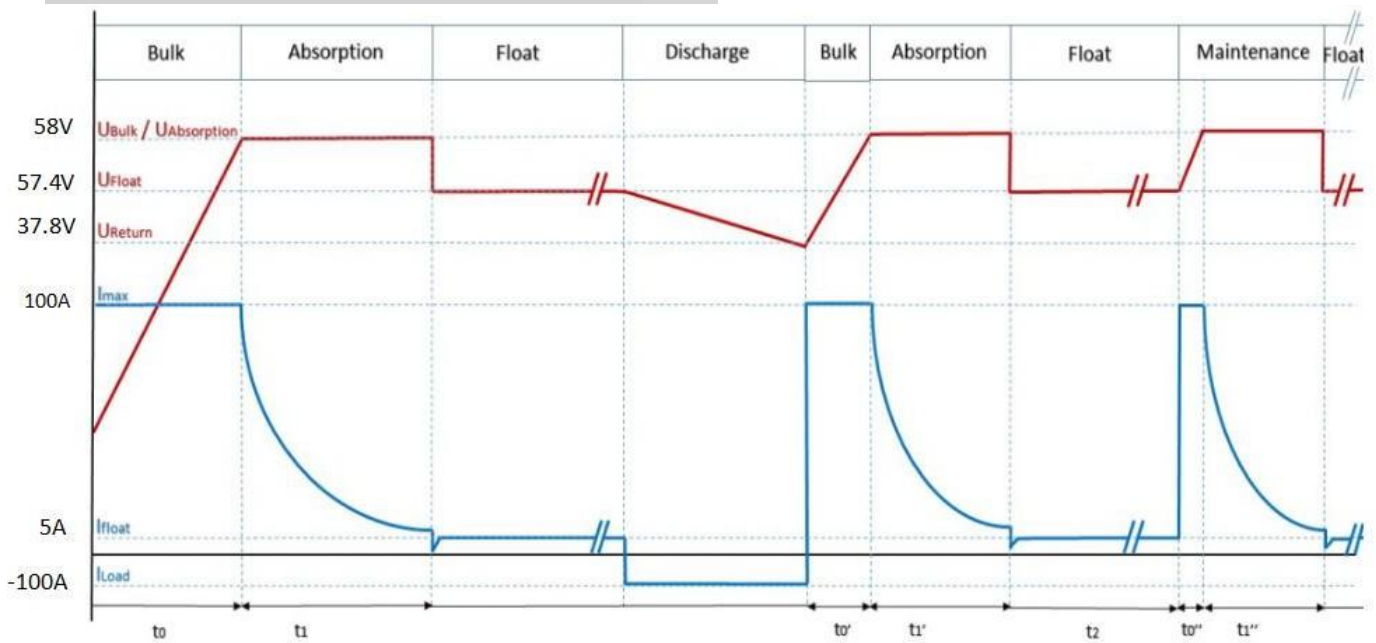

**Note:** If the charger needs to set the floating charge voltage, it is recommended to set the UFloat value to 57.4V.